

Ford Full Size Van Assembly – Installation Instructions

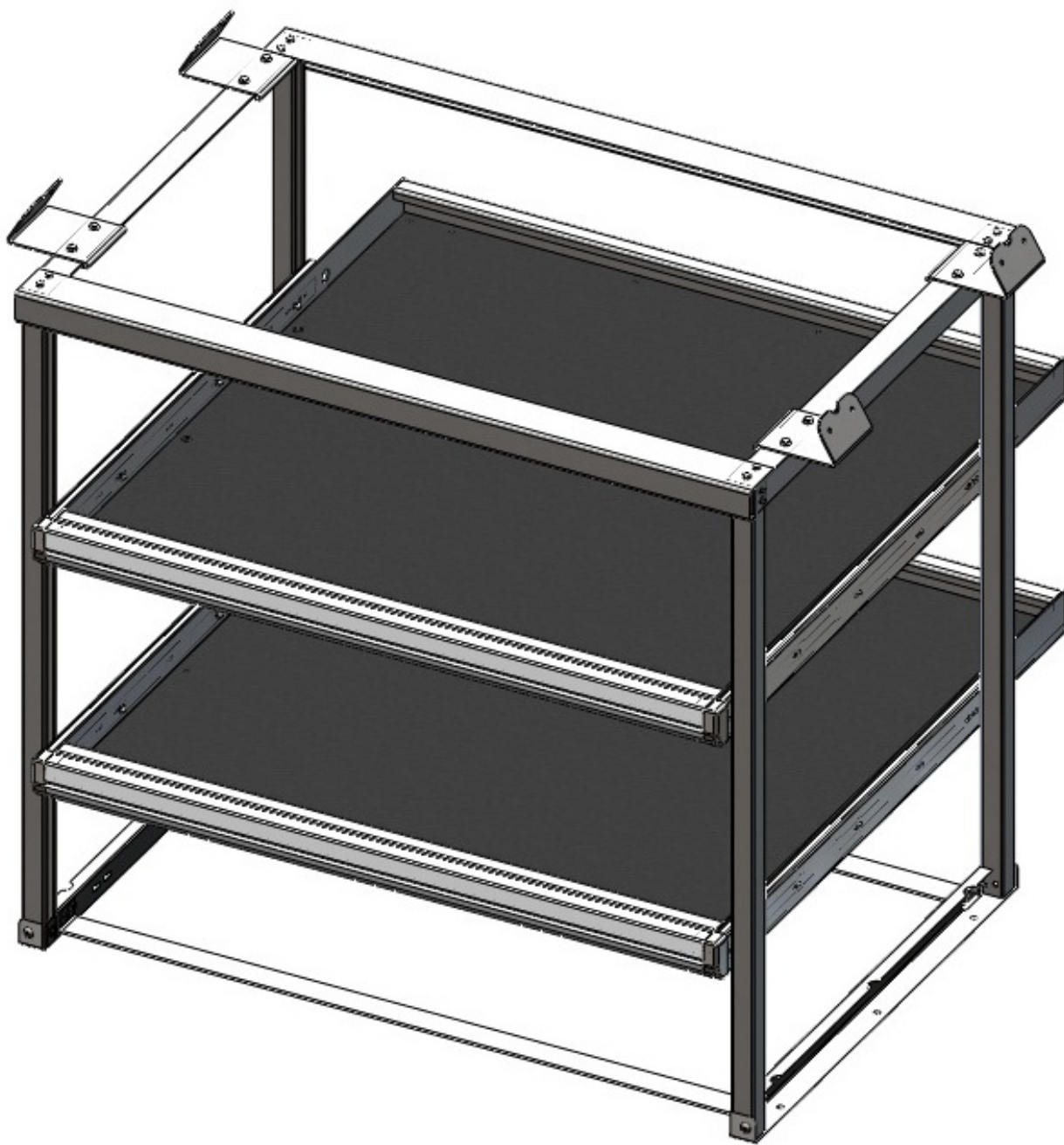

BEFORE YOU START!

IMPORTANT INSTALLATION STEPS ARE DENOTED USING A STOP SIGN. THESE STEPS MUST BE PERFORMED IN THE SPECIFIED ORDER TO ENSURE PROPER INSTALLATION AND MUST BE FOLLOWED IN ORDER TO MAINTAIN YOUR PRODUCT WARRANTY!



CRITICAL INFORMATION PERTAINING TO USER AND/OR VEHICLE SAFETY IS DENOTED USING A CAUTION SIGN. SAFETY ITEMS MUST BE STRICTLY ADHERED TO IN ORDER TO ENSURE A SAFE WORKING ENVIRONMENT!



WARNING



THE USE OF DRILLS WITH INTEGRAL DRILL STOPS ALONG WITH PROPER INSPECTION FOR GAS TANK, GAS LINES, BRAKE LINES AND ELECTRICAL LINES PRIOR TO DRILLING ANY MOUNTING HOLES IS STRONGLY RECOMMENDED TO ENSURE THAT VEHICLE DAMAGE IS AVOIDED!



THE USE OF AIR OR ELECTRIC IMPACT TOOLS FOR THE ASSEMBLY OF FASTENERS COULD CAUSE FASTENER FAILURE!



THE USE OF NON-STANDARD FASTENERS AND/OR DEVIATING FROM THE FASTENERS SPECIFIED IN THESE INSTRUCTIONS MAY VOID YOUR PRODUCT WARRANTY!



ALL DRILLED HOLES IN THE VEHICLES SHOULD HAVE THE RAW METAL EDGES SEALED WITH A SELF-ETCHING PRIMER TO RESIST CORROSION AND POTENTIAL FASTENER POINT FAILURE!



TOOL LIST



Safety glasses **MUST** be worn at all times!



Drill



5/16" & 1/4" Drill Bits



1/2" Drill Stop



7/16" & 1/2" Sockets



Ratchet Wrench



7/16" & 1/2"
Combination End Wrenches

RECOMMENDED:
- PNEUMATIC PLUS NUT GUN

STEP 1 – Fasten Bottom Brace to Side Frame Assemblies

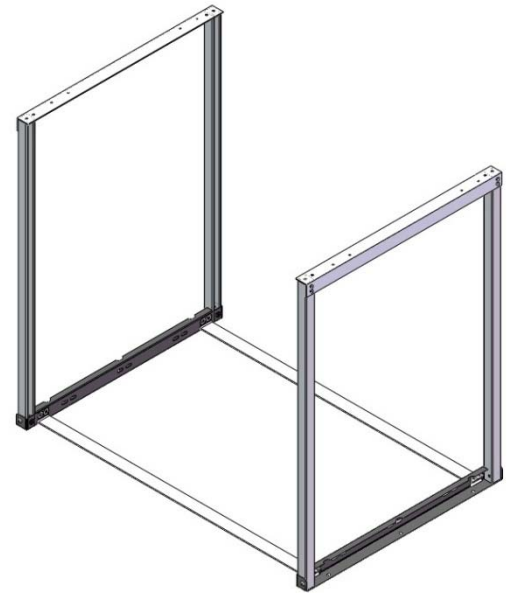
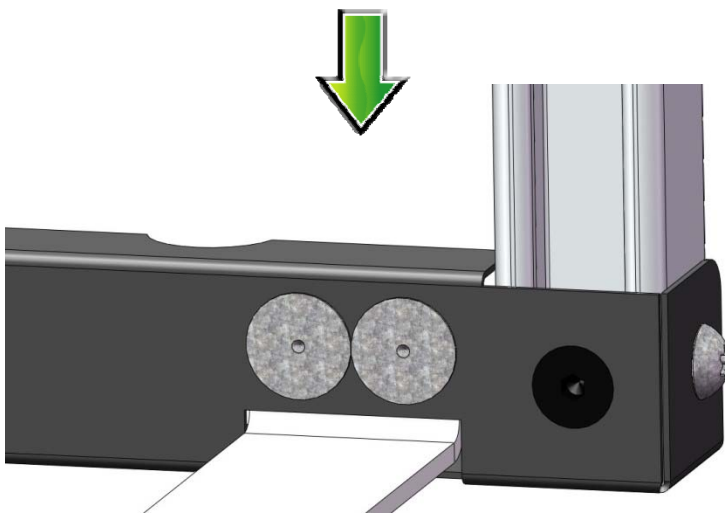
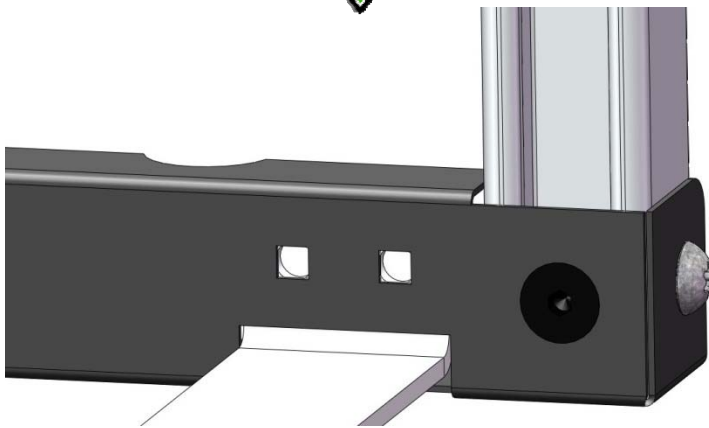
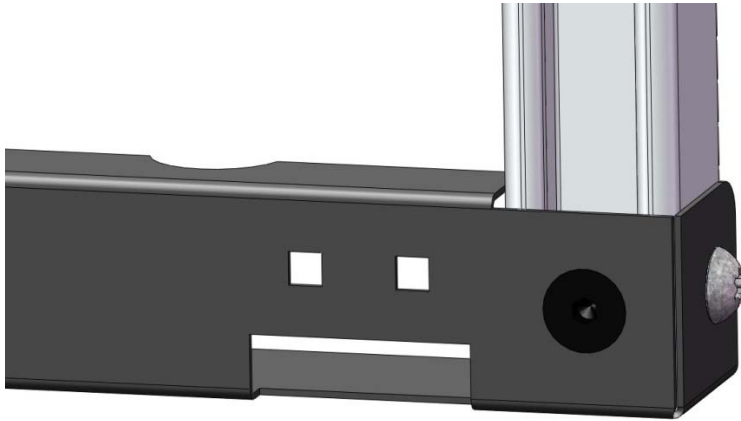

Side frames fully fastened to bottom braces.

- Insert the bottom brace into the slot cut into the bottom of the side frame assembly.
- Fasten the bottom brace to the side assembly using the 1/4-20 elevator bolts and 1/4-20 Nylock nuts.
- Repeat above steps for the second bottom brace.
- Once completed, frame should look like above photo.

STEP 2 – Insert the Assembly into the Van



IMPORTANT
YOU WILL NEED TWO PEOPLE TO COMPLETE THIS OPERATION!



NOTICE
THE TOP OF THE SIDE ASSEMBLIES NEED TO BE FLEXED INWARD TO CLEAR THE DOOR OPENINGS



- Insert the partially assembled frame into the back of the van.

STEP 3 – Fasten Top Cross Braces to the Side Frame Assemblies

- Line up the holes in the cross brace with the holes on the top of the side frame.
- Insert (4) of the provided 1/4-20 x 3/4" bolts and securely fasten with the remaining 1/4-20 Nylock nuts.
- Repeat above steps for the opposite top cross brace.

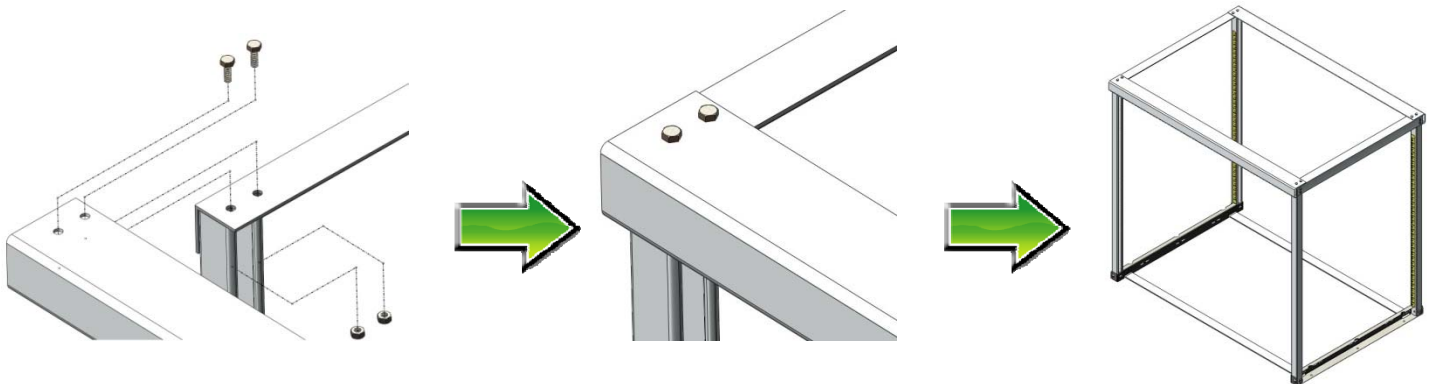

STEP 4 – Fastening DuraRac to the floor of the Van

- Line up the edges of the DuraRac Baseplates 8" from the door openings as seen in the below photo.



NOTICE: Check that the frame is square during assembly!



- After making sure that the frame is square, center the DuraRac frame in between the wheel wells.
- Bolt through the floor using the supplied 5/16 x 1 3/4" hex bolt.



BEFORE DRILLING
Check all mounting locations to prevent penetration of:
gas lines, gas tanks, break lines, wiring or any other structure
of the vehicle



- Bolt locations are shown on the next page.

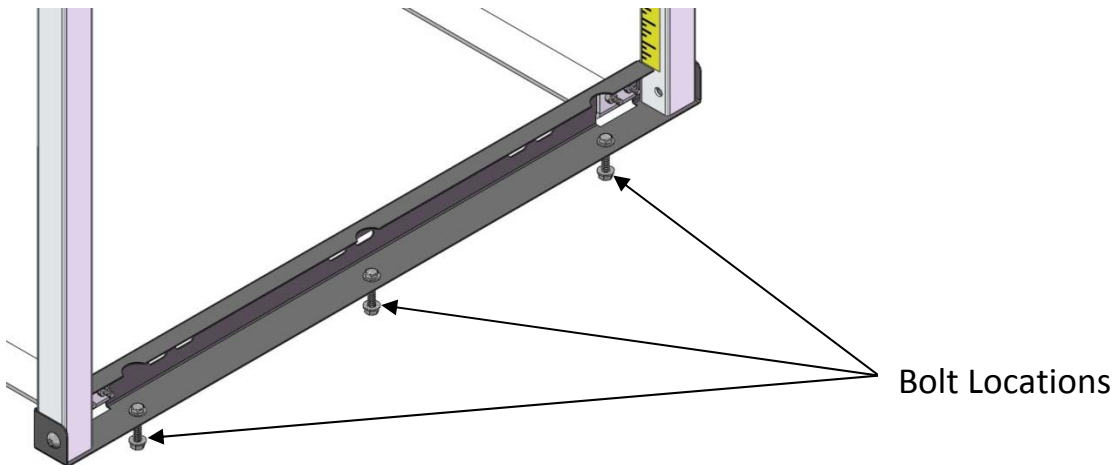

* If any obstructions are found, plus nuts will have to be installed

STEP 5 – Locating and Fastening the Mount Bracket to the DuraRac Frame

REAR MOUNTING BRACKET LOCATION

- The rear mounting bracket lines up with the sheet metal weld seam on the van as shown on the bottom right image.
- Use the mounting bracket as a drill template and mark hole locations on the van wall and DuraRac frame.
- Drill holes in proper locations and insert plus nuts in the two holes on the van wall. Refer to sheet 9 for proper plus nut installation instruction.

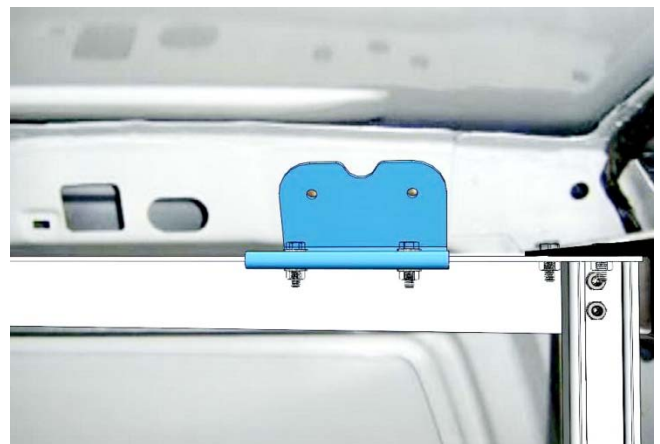
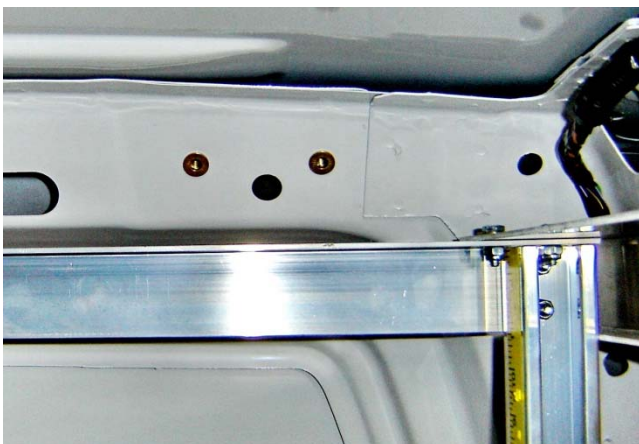

FORWARD MOUNTING BRACKET LOCATION

- The forward mounting bracket butts up against the top cross brace (see image below).
- Use the mounting bracket as a drill template and mark hole locations on the van wall and DuraRac frame.
- Drill holes in proper locations and insert plus nuts in the two holes on the van wall. Refer to sheet **9** for proper plus nut installation instruction.

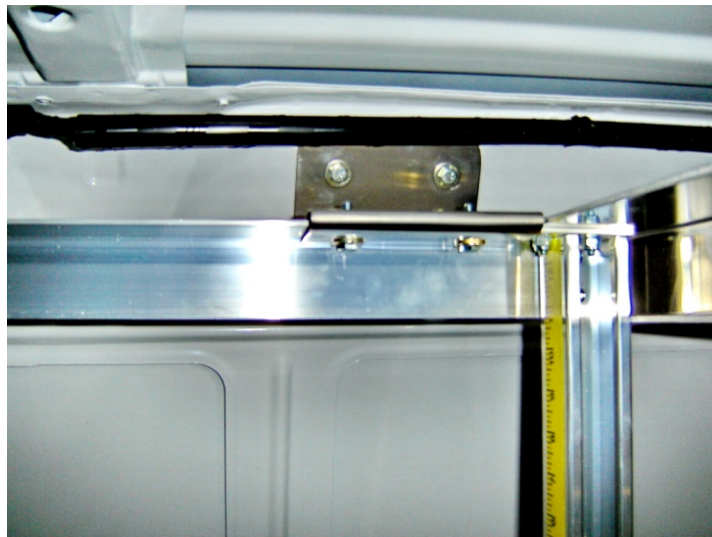

FASTENING THE MOUNTING BRACKETS

- To fasten the mounting brackets to the DuraRac frame, use (2) 1/4-20 x 1" bolts, (4) 1/4 SAE flat washers, and (2) 1/4-20 Nylock per mounting bracket.
- To fasten the mounting tab to the van wall use the (2) of the 1/4-20 x 1 1/4" bolts.

How to Install Plus Nuts

BEFORE DRILLING

Check all mounting locations to prevent penetration of:
gas lines, gas tanks, break lines, wiring or any other structure
of the vehicle

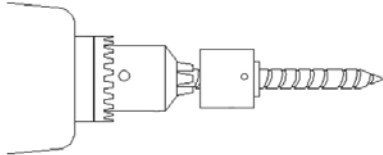

USE DRILL STOP TO PREVENT DAMAGE TO VEHICLE

FIRST METHOD: MANUAL



1) The plus nut is pre-bulbed for easy installation.



2) The plus nut is pre-assembled with hex cap and hex bolt. Then it is inserted into a pre-drilled hole.

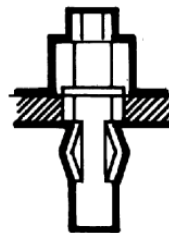

3) As the bolt is tightened, the plus nut upsets and provides outstanding blind fastening holding power.



4) Fully upset plus nut provides a reliable nut plate for fastening.

SECOND METHOD: AUTOMATIC (REQUIRES PNEUMATIC PLUS NUT GUN)

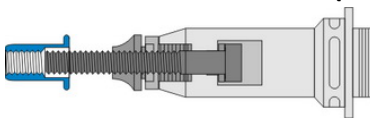

1. Thread plus nut onto plus nut gun.

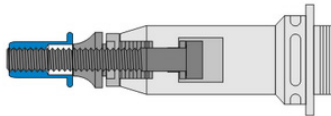

2. Insert plus nut into hole. Engage plus nut gun to upset plus nut.

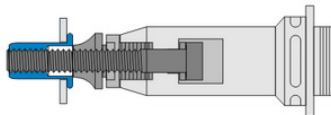

3. When plus nut is fully upset and expanded, remove plus nut gun.

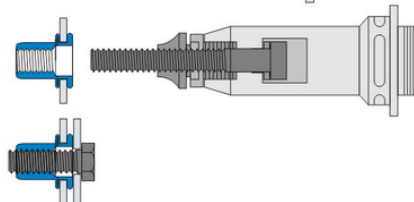



IMPORTANT!
BEFORE MOUNTING SHELVING UNITS, SQUARE UP THE DURARAC FRAME AND MAINTAIN 48 5/8" IN BETWEEN THE UNISTURT IN BOTH THE FRONT AND REAR OF THE DURARAC FRAME.



STEP 6 – Installing the Drawer Assemblies

- Insert strut nut into the strut channel (spring will hold it in place). Align all (4) strut nut inserts vertically.
- Extend drawer fully to the lock out position. This position will allow access to the predrilled holes in the slides. Using supplied 1/4"-20 x 1" flathead bolt, tighten or leave loose for final vertical adjustment. Then tighten all (4) bolts.
- Check drawers for proper function.

INSTALLATION COMPLETE

BILL OF MATERIALS

ITEM NO.	PART NO.	DESCRIPTION	QTY.
1	DTC 0801-020	DURARAC, SIDE FRAME ASSEMBLY.	2
2	DTC 0213-042	BOTTOM BRACE, FULL KATERACK	2
3	DTC 0213-041	TOP CROSS BRACE, FULL KATERACK	2
4	FAS 1119903	BOLT, FLANGE, 1/4-20 x 3/4" ZINC	8
5	FAS 1137018	NUT, NYLOCK 1/4-20	24
6	FAS 0144612	BOLT, ELEVATOR, 1/4-20 x 3/4"	8
7	FAS 10826	BOLT, HEX, 5/16-18 x 1 3/4" FULL THD.	6
8	DTC 0213-043	UPPER MOUNT BRACKET, FORD	4
9	FAS 1119905	BOLT, FLANGE, 1/4-20 x 1" ZINC	8
10	FAS 1133004	1/4" ZINC FLAT WASHER	16
11	FAS 12319-00491	PLUS NUT, 1/4-20	8
12	FAS 13007	SCREW, HEX CAP, 1/4-20 x 1 1/4"	8
13	DTC 0803-010	DURARAC, STD. DRAWER	2
14	FAS 48603	NUT, CHANNEL, 3/8-16 W/ SPRING	4 PER SHELF
15	FAS 1124286	CAP, SOCKET, FLAT, 3/8-16 x 1"	4 PER SHELF

Exploded View
See Bill of Material on Previous Page

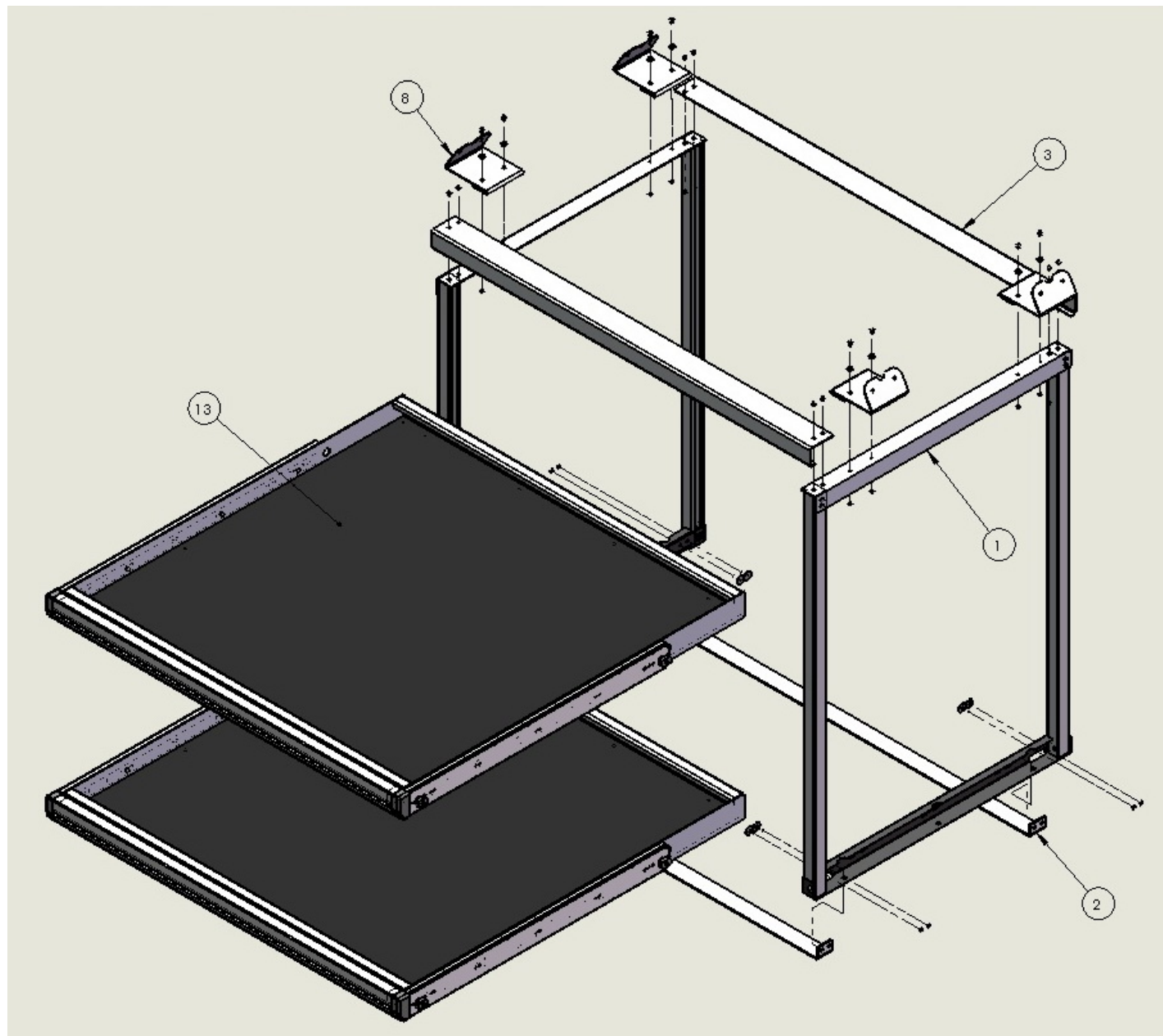

DuraRac Inspection Dimensions

